

CLY 760 260

350kg Service Cable Drum Trailer

User Instructions



Read this manual carefully, observing all the operating and safety instructions before and during use. This equipment has been manufactured to conform to current EEC Directives and is issued with a Declaration of Conformity.

DESCRIPTION

Self-loading trailer which facilitates the handling of a single cable drum and the dispensing of cable and conductor.

TECHNICAL SPECIFICATIONS

Max. No. of Drums:	1
Max. Drum Diameter:	850mm
Max. Drum Width:	550mm
Min. Spindle Hole Diameter	70mm
Max. Drum Weight:	350kg
Length:	3670mm
Width:	2320mm
Min. Ground Clearance:	235mm
Coupling Height:	330mm
Unladen Weight:	165kg
Max Laden Weight:	515kg

Clydesdale Ltd.

Instal House, 3 Sunbeam Road,
Woburn Road Ind. Est., Kempston,
Bedfordshire MK42 7BZ
United Kingdom

Tel: +44 (01234) 855855
Fax: +44 (01234) 855800
E-mail: sales@clydesdale.net
www.clydesdale.net

CLY 760 260

350kg Service Cable Drum Trailer

User Instructions



Hand Winch:	Treuids Goliath 340kg
Wheel & Tyre:	520R10 4 Ply, 4 x 4" PCD M10 Studs
Mudguards:	Black Plastic
Coupling:	50mm Ball Knott KQ14
Suspension Units:	Knott 550kg
Lighting:	12V RTA Compliant L& R Rear Marker, Indicator and Stop Lamps. L & R Front White Reflectors.

OPERATING INSTRUCTIONS

GENERAL SAFETY WARNINGS:

ATTENTION Trailer must be connected to vehicle for all operations i.e. loading drums, dispensing cable and unloading drums. This is necessary to provide stability and a safe working condition.

ATTENTION All areas around the trailer should be treated as Danger Zones.

ATTENTION This equipment should not be used when there is a possibility of lightning.

ATTENTION Whilst towing the trailer the mandatory speed limits are not to be exceeded!

ATTENTION Ensure at all times the trailer is carrying a drum that the two quick release yokes on the lifting frame are locked!

ATTENTION During manoeuvring of the trailer ensure feet are clear of jockey and road wheels to avoid crushing hazard.

ATTENTION Read warning label mounted on top of towing hitch regarding potential dangers.

LOADING DRUMS ONTO TRAILER

SPECIFIC SAFETY WARNINGS

ATTENTION During loading ensure hands are clear of sides of the cable drum to avoid crushing and shearing hazard.

ATTENTION During loading and unloading ensure feet are clear of underside of cable drum to avoid crushing hazard.

ATTENTION Do not transport drum on the trailer without the locking pin in position.

Clydesdale Ltd.

Instal House, 3 Sunbeam Road,
Woburn Road Ind. Est., Kempston,
Bedfordshire MK42 7BZ
United Kingdom

Tel: +44 (01234) 855855
Fax: +44 (01234) 855800
E-mail: sales@clydesdale.net
www.clydesdale.net

CLY 760 260

350kg Service Cable Drum Trailer

User Instructions

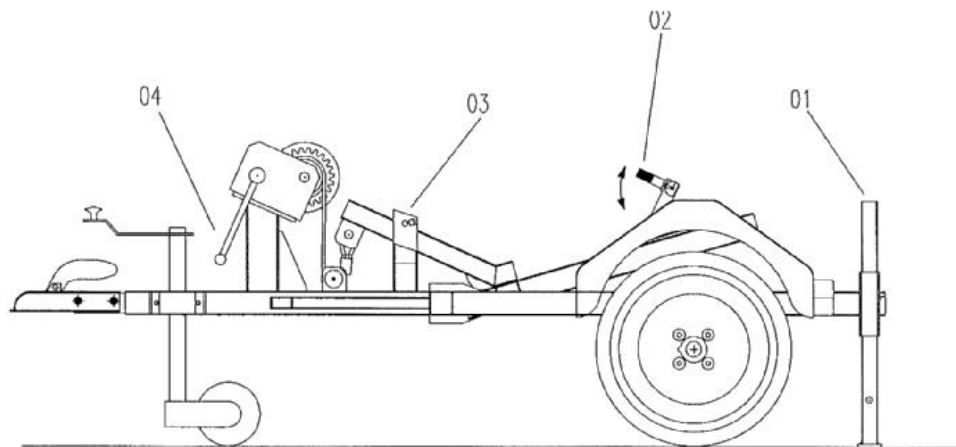

1. Ensure the trailer is on reasonably level ground, and is hitched to a suitable vehicle. The stabiliser legs (01) should be lowered and pinned in position.
2. Ensure that the yoke locks (02) are rotated to their open position shown and that the locking pin (03) is removed.
3. Remove the drum shaft and place in the centre of the drum to be lifted.
4. Rotate the handle (04) anticlockwise on the hand winch to lower the lifting frame to its horizontal position.
5. Locate the cable drum and shaft centrally into the lifting frame yokes ensuring that the two flanges on the one end of the drum shaft straddle a yoke.
6. Rotate the yoke locks down to their locked position.
7. Rotate winch handle (04) clockwise to lift the cable drum to its fully raised position. Replace the locking pin (03).
8. Unloading a drum from the trailer is the reverse sequence of the above.

MAINTENANCE

It is essential that your machine receives regular attention to ensure that it remains in peak condition. All the road running gear i.e. brakes, lights, mudguards, tyres etc. are statutory requirements and as such must be maintained in good condition. Other checks essential to smooth and safe operation are as follows:

- General check over for loose nuts, bolts, fittings etc.
- Stabiliser leg retaining pins should be checked for damage and that R-Clips are present and in working order.
- Lifting frame yokes should be regularly greased. (Recommended lubricant EP2- ISO 46 grease)
- All grease points should be regularly greased. (Recommended lubricant EP2- ISO 46 grease)
- Hand winch and rope should be regularly checked for correct operation.
- Check tyre pressures are 35psi. This value is not to be exceeded.

Clydesdale Ltd.

Instal House, 3 Sunbeam Road,
Woburn Road Ind. Est., Kempston,
Bedfordshire MK42 7BZ
United Kingdom

Tel: +44 (01234) 855855
Fax: +44 (01234) 855800
E-mail: sales@clydesdale.net
www.clydesdale.net

EC DECLARATION OF CONFORMITY

MANUFACTURER..... Clydesdale
Ltd.
Install House
3 Sunbeam Road

Woburn Road Ind.Est.
Kempston , Beds
MK42 7BZ

In accordance with **The Supply of Machinery (Safety) Regulations 1992** we hereby declare that the product described conforms with the Essential Health And Safety Requirements , the following EEC Directive: **98/37/EC** and the following transposed harmonised standards : **EN 292-1** , **EN 292-2** and **EN 1050**.

SIGNED



POSITIONManaging Director.....

PRODUCT DESCRIPTION350kg Service Cable Drum Trailer.....

MODELCLY 760 260.....

SERIAL NUMBER

TEST CERT. NUMBER.....

DATE OF MANUFACTURE