

# CLY 760 350: 350KG CABLE DRUM TRAILER Data Sheet

# CLYDESDALE

## Powering the Future

**Clydesdale Ltd.**  
Instal House, 3 Sunbeam Rd  
Woburn Road Ind. Est., Kempston  
Bedfordshire MK42 7BZ  
United Kingdom

T: +44 (0) 1234 855 855  
F: +44 (0) 1234 855 800  
E: sales@clydesdale.ltd.uk  
www.clydesdale.ltd.uk

**Drop & Pin Stabiliser Legs:**  
Quick and simple function,  
creates support on the  
roughest of surfaces.

**RTA Compliant 12V Lighting:**  
Fitted as standard.

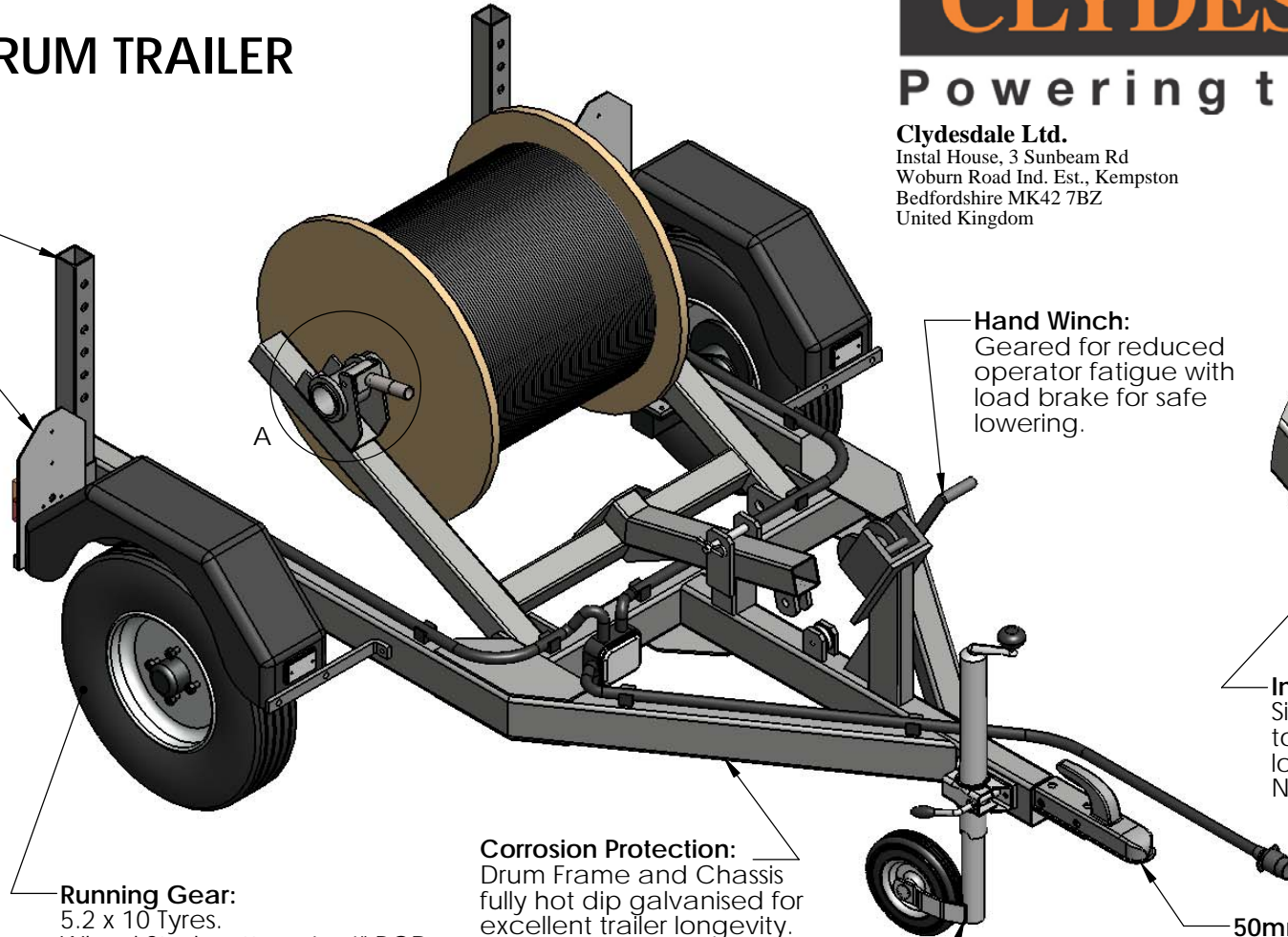
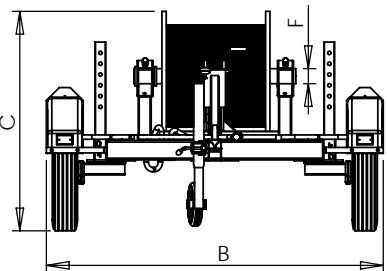
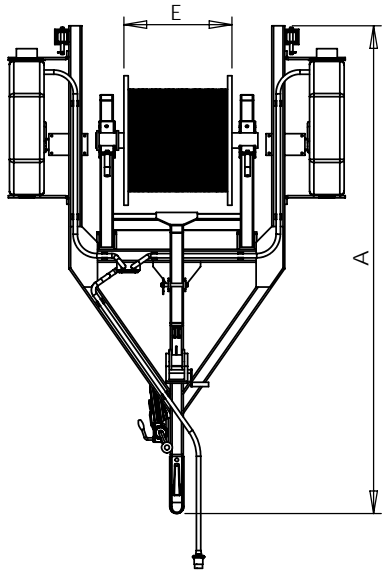

**DETAIL A**

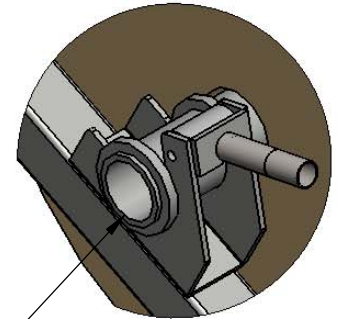

**Hand Winch:**  
Geared for reduced  
operator fatigue with  
load brake for safe  
lowering.

**Innovative Shaft Holders:**  
Simply pull and raise levers  
to release shaft, pull and  
lower to lock shaft in place.  
No more lose parts to loose.

**Running Gear:**  
5.2 x 10 Tyres.  
Wheel Stud pattern 4 x 4" PCD  
550kg Unbraked Suspension Units  
HD Plastic Mudguards

**Corrosion Protection:**  
Drum Frame and Chassis  
fully hot dip galvanised for  
excellent trailer longevity.

**50mm Pressed Steel Head:**  
Fitted as standard. Other  
options available on request.

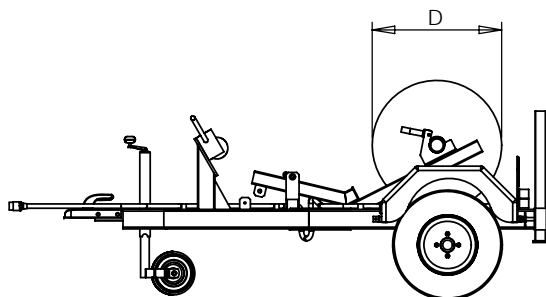

**Jockey Wheel:**  
48mm Smooth Shaft  
with pressed steel  
clamp and solid  
rubber tyre. Sturdy  
and easy to use.

<b>Trailer Length</b>	A	2260mm
<b>Trailer Width</b>	B	1560mm
<b>Max Loaded Trailer Height</b>	C	1120mm
<b>Max Drum Diameter</b>	D	800mm
<b>Max Drum Width</b>	E	540mm
<b>Min Spindle Hole Diameter</b>	F	70mm
<b>Max Drum Weight</b>		350kg
<b>Unladen Weight</b>		165kg
<b>Max Laden Weight</b>		515kg